

Lead Screw

Linear actuation for positioning tasks
PRECiStep® Technology

For combination with
Stepper Motors: DM0620, AM0820, AM1020

Series M1,6 x 0,35 x L1

Nominal diameter	1,6	mm
Pitch	0,35	mm
Material	Stainless steel	

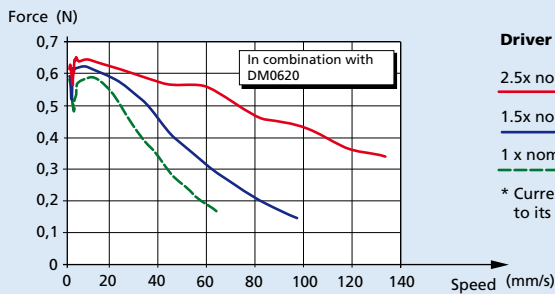

Driver settings
 2.5x nominal voltage *
 1.5x nominal voltage *
 1 x nominal voltage
 * Current limited to its nominal value

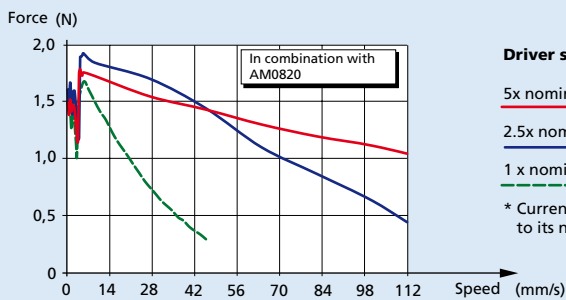

Driver settings
 5x nominal voltage *
 2.5x nominal voltage *
 1 x nominal voltage
 * Current limited to its nominal value

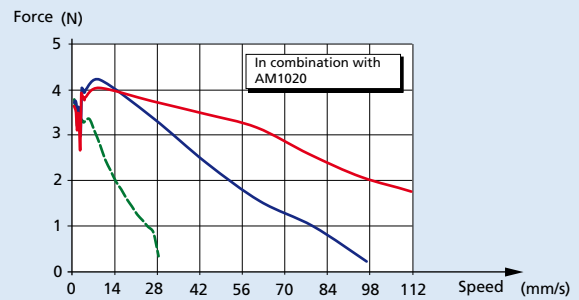

Important notes: The thrust curves include already a safety factor for the use of the stepper motor.
Please read the "Technical information" for a better understanding of the curves.

Ordering information	L1 (mm) =	7,5	15	25	Custom
Order code (no bearing tip)		M1.6x7.5	M1.6x15	-	M1.6xL1*
Order code (with bearing tip)		-	M1.6x15T	M1.6x25T	M1.6xL1T*

* For custom length, please inquire with your point of sales

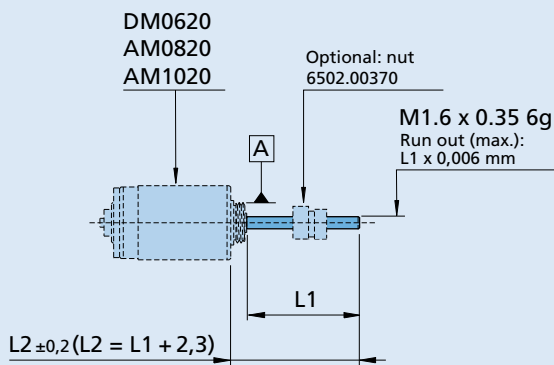

M1,6 x 0,35 x L1

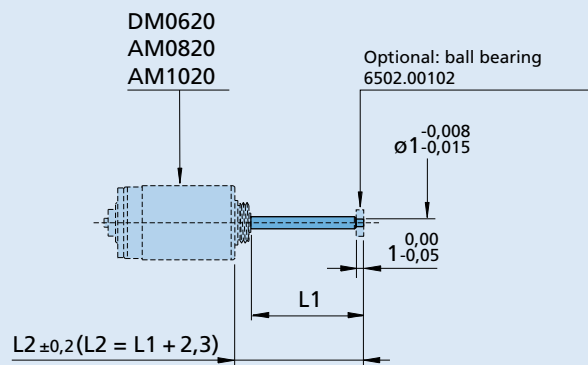

Version with bearing tip
M1,6 x 0,35 x L1 T

Lead Screw

Optional nuts and bearings
PRECiStep® Technology

Options

For M1,2 x 0,25 Lead screws

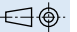
Scale 2:1 

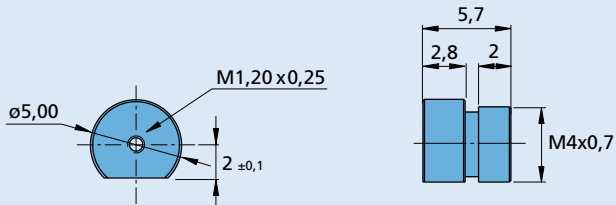

Nut Part No. 6502.00366, Self-lubricating synthetics material

For M1,6 x 0,35 Lead screws

Scale 2:1 

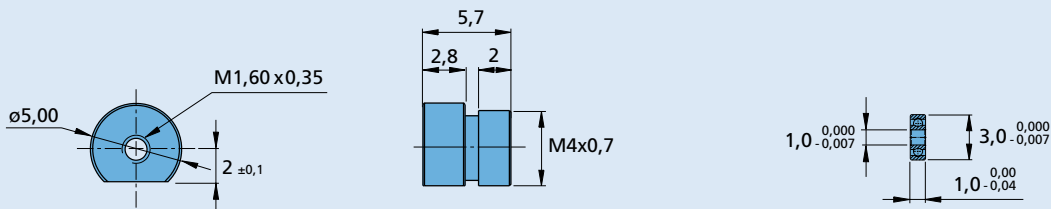

Nut Part No. 6502.00370, Self-lubricating synthetics material

Bearing for leadscrew tip Part No. 6502.00102

For M2,0 x 0,2 Lead screws

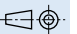
Scale 2:1 

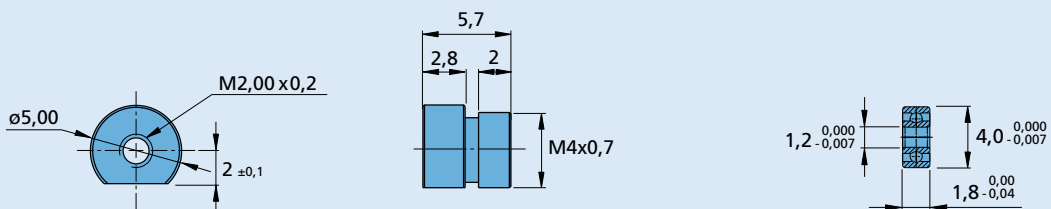

Nut Part No. 6502.00337, Self-lubricating synthetics material

Bearing for leadscrew tip Part No. 6502.00097

For M3,0 x 0,5 Lead screws

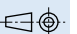
Scale 2:1 

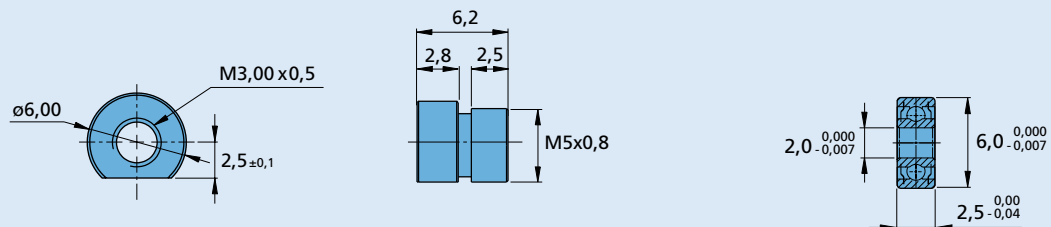

Nut Part No. 6502.00323, Self-lubricating synthetics material

Bearing for leadscrew tip Part No. 6502.00103