

# Lead Screw

Linear actuation for positioning tasks  
PRECiStep® Technology

For combination with  
Stepper Motors: DM0620, AM0820, AM1020

## Series M1,2 x 0,25 x L1

|                  |                 |    |
|------------------|-----------------|----|
| Nominal diameter | 1,2             | mm |
| Pitch            | 0,25            | mm |
| Material         | Stainless steel |    |

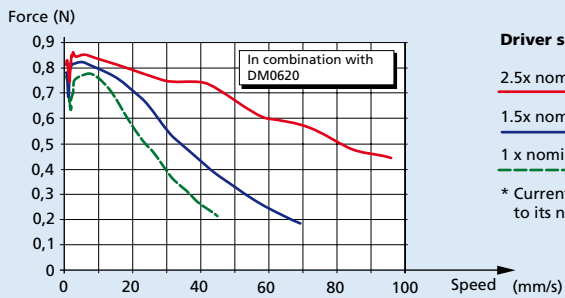

**Driver settings**

- 2.5x nominal voltage \*
- 1.5x nominal voltage \*
- 1 x nominal voltage

\* Current limited to its nominal value

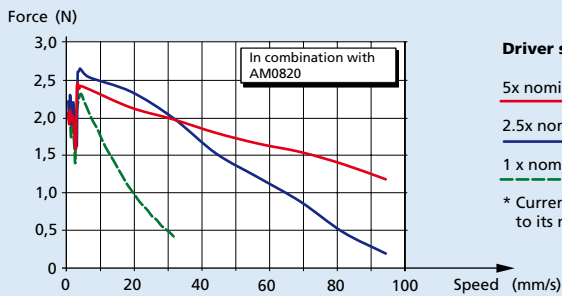

**Driver settings**

- 5x nominal voltage \*
- 2.5x nominal voltage \*
- 1 x nominal voltage

\* Current limited to its nominal value

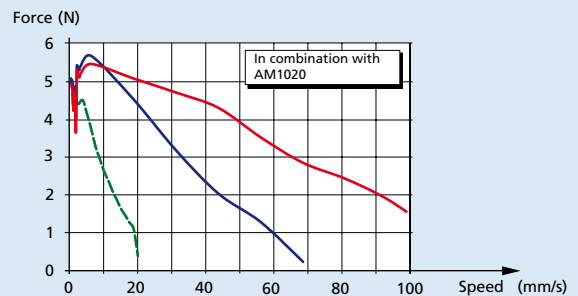

**Important notes:** The thrust curves include already a safety factor for the use of the stepper motor.  
Please read the "Technical information" for a better understanding of the curves.

| Ordering information          | L1 (mm) = | 7,5      | 15      | Custom   |
|-------------------------------|-----------|----------|---------|----------|
| Order code (no bearing tip)   |           | M1.2x7.5 | M1.2x15 | M1.2xL1* |
| Order code (with bearing tip) |           | -        | -       | -        |

\* For custom length, please inquire with your point of sales

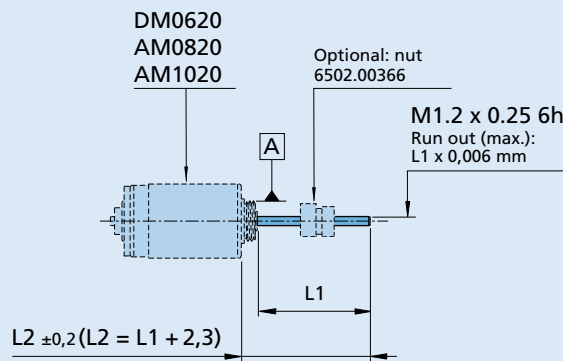

**M1,2 x 0,25 x L1**

# Lead Screw

Optional nuts and bearings  
PRECIstep® Technology

## Options

For M1,2 x 0,25 Lead screws

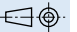
Scale 2:1 

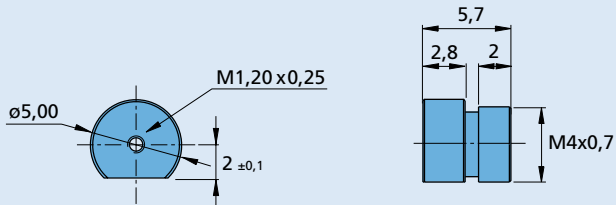

Nut Part No. 6502.00366, Self-lubricating synthetics material

For M1,6 x 0,35 Lead screws

Scale 2:1 

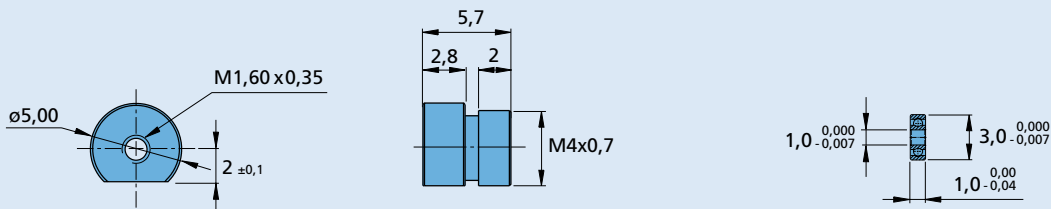

Nut Part No. 6502.00370, Self-lubricating synthetics material

Bearing for leadscrew tip Part No. 6502.00102

For M2,0 x 0,2 Lead screws

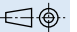
Scale 2:1 

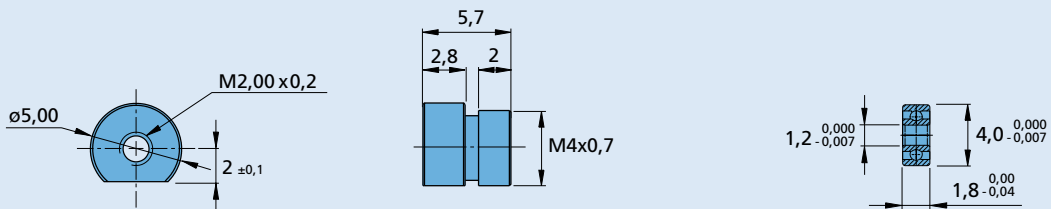

Nut Part No. 6502.00337, Self-lubricating synthetics material

Bearing for leadscrew tip Part No. 6502.00097

For M3,0 x 0,5 Lead screws

Scale 2:1 

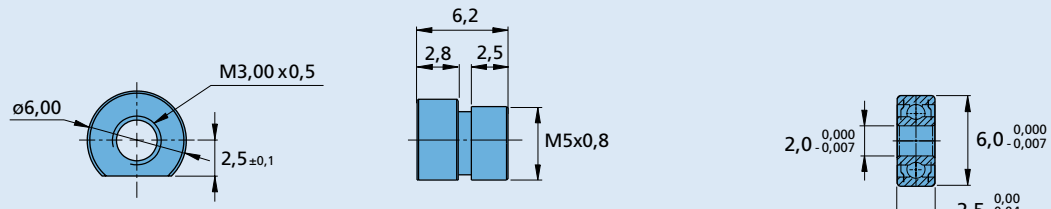

Nut Part No. 6502.00323, Self-lubricating synthetics material

Bearing for leadscrew tip Part No. 6502.00103