

# 丝杠

## 直线定位

适配部件  
步进电机

### M2 x 0.2 x L1 系列

订货代码	L1 (mm) =	15	25	28/30	定制
名称 (无顶端轴承)		M2x15	M2x25	M2x30	M2xL1*
名称 (带顶端轴承)		M2x15T	M2x25T	M2x28T	M2xL1*T
标称外径	2,0				mm
螺距	0,2				mm
材质	不锈钢				

\* 若需订制长度, 请联系当地销售代表。

#### 适配部件步进电机 AM0820, AM1020, DM1220, AM1524

##### 重要说明

推力曲线已考虑了对应电机的安全余量。为更好理解曲线含义, 请阅读“技术信息”章节。

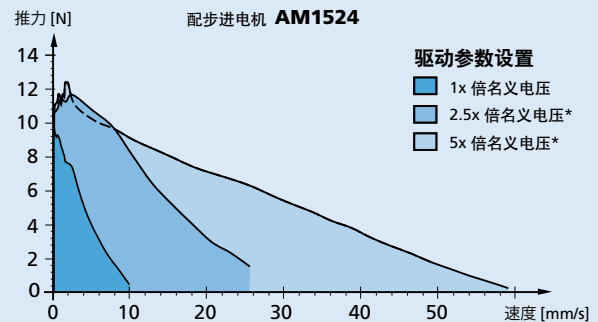
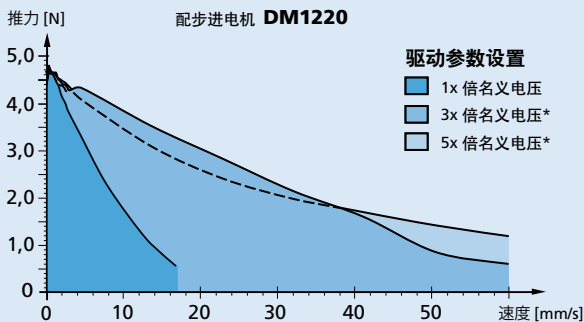
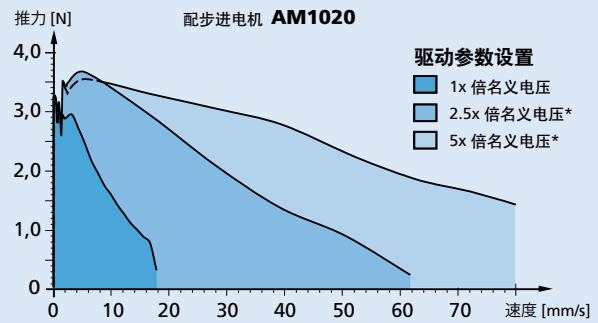
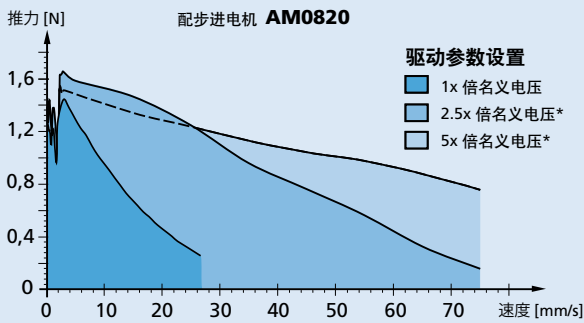

\* 电流以名义电流值为限

#### 尺寸图

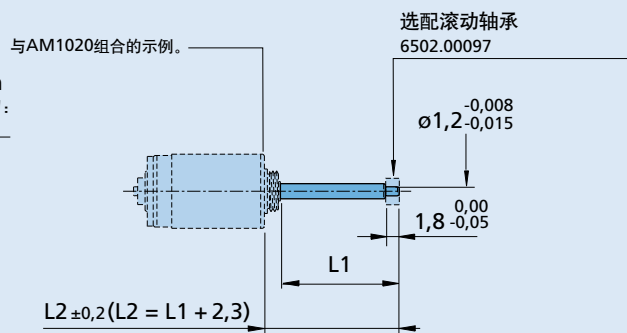
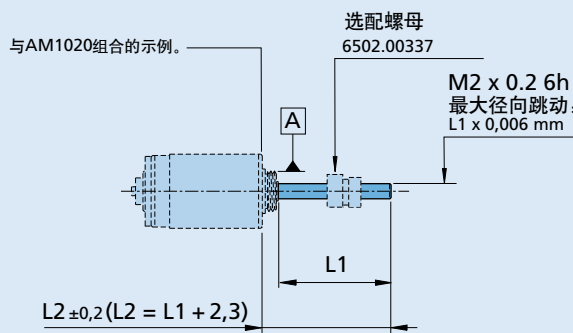

M2,0 x 0,2 x L1

带顶端轴承  
M2,0 x 0,2 x L1 T

# 丝杠

## 螺母与轴承选配件

### 选配件

适配 M1.2 x 0.25 丝杠

比例: 2:1 

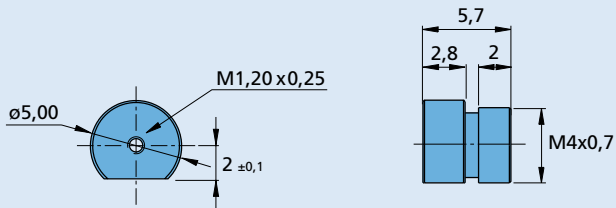

螺母订货代码: 6502.00366, 自润滑合成材质

适配 M1.6 x 0.35 丝杠

比例: 2:1 

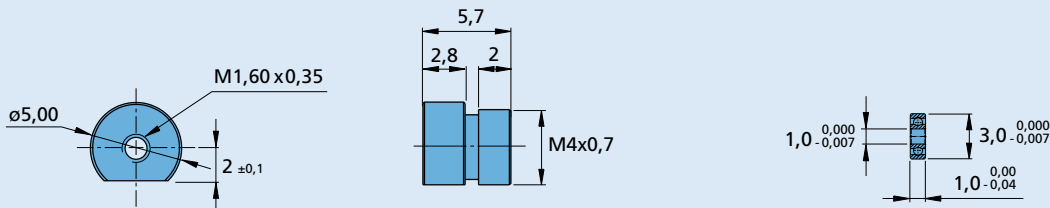

螺母订货代码: 6502.00370, 自润滑合成材质

丝杠顶端轴承订货代码: 6502.00102

适配 M2.0 x 0.2 丝杠

比例: 2:1 

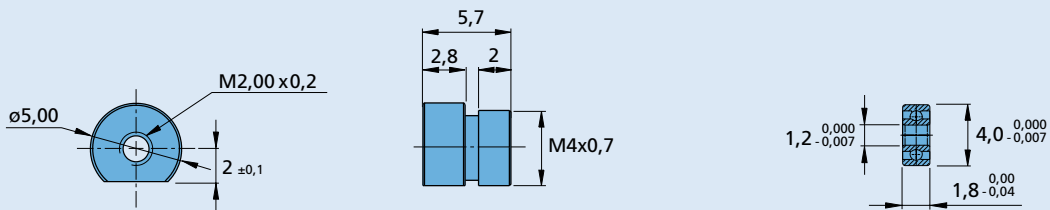

螺母订货代码: 6502.00337, 自润滑合成材质

丝杠顶端轴承订货代码: 6502.00097

适配 M3.0 x 0.5 丝杠

比例: 2:1 

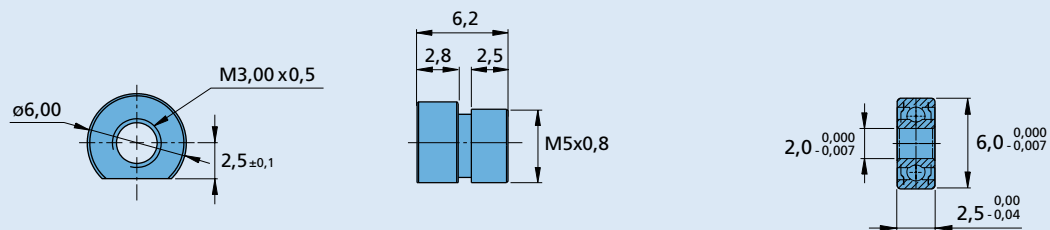

螺母订货代码: 6502.00323, 自润滑合成材质

丝杠顶端轴承订货代码: 6502.00103